



Volume

3

MODIWALL (PTY) LTD

Modular Vertical Garden System

Quick Installation Guide and General Instructions

Plants

It is a good idea to speak to your local nursery before purchasing the plants or installing the Modiwall panel. Find out what kind of plants grow well in the area. As well as what kind of conditions they prefer, depending on the location of your Vertical Garden (Full-sun, or shade). Also try to pick plants that grow fast and lush, that way your system will look fabulous in no time.

Important: Purchase plants that will fit into the Modiwall pots

- 6 deep packs
- 10 cm potted plants
- 12 cm potted plants
- Some 1litre plants that can be split in two
- Seedlings
- Seeds

Installation guide

Step 1. Position the Grid where you are planning to install. Use a level to make sure it is level

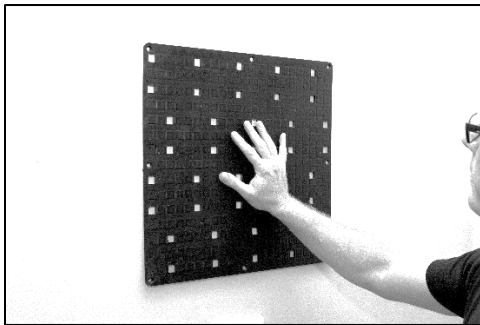

Step 2. Mark the 4 corners, and the top hole with a pencil (5 in total)

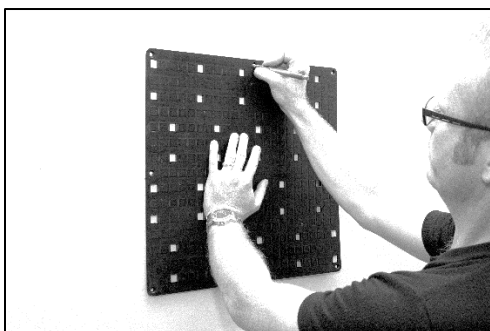

Step 3. Drill the 5 holes and insert wall plug

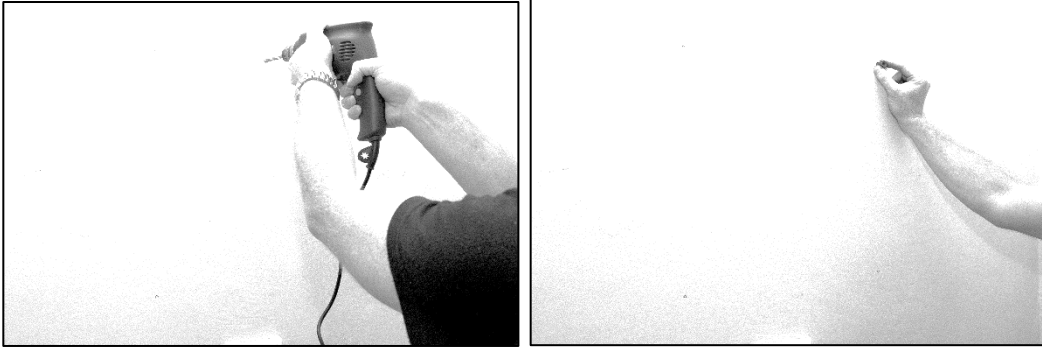

Step 4. Now put the screw through the grid hole, then add the spacer, and then insert into the screw hole

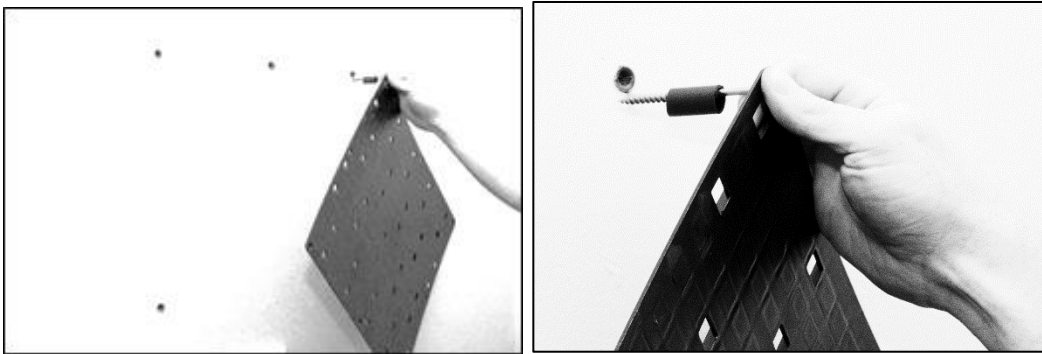

Step 5. Fasten with a star point screwdriver

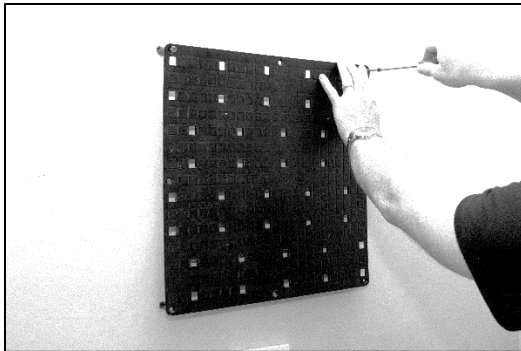

Step 6. Insert pots (click in)

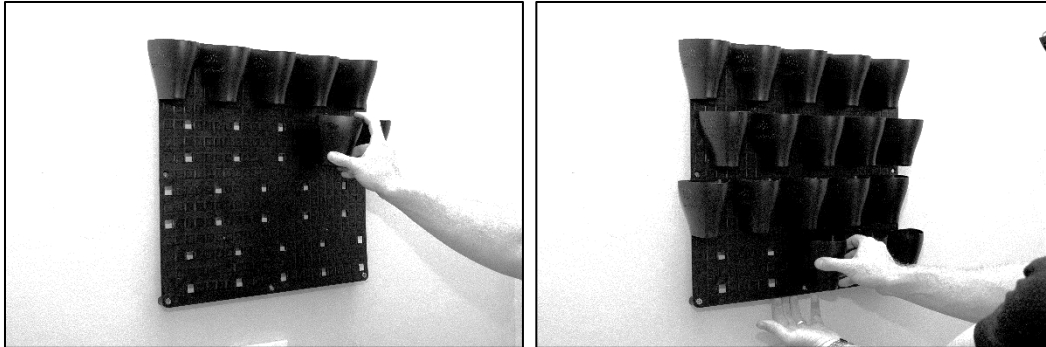

Step 7. Add some stones to the bottom of the pot for better drainage

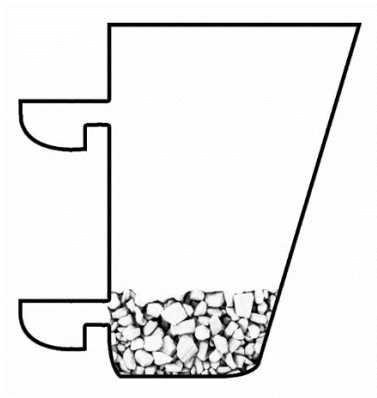

Step 8. Plant the plants – If you bought pre-planted plants, don't remove the soil they are in. Plant them as is. Leave some space in the rim of the pot for water to accumulate and seep into the soil (Don't over-fill the pot with soil)



*** If you are installing multiple panels, measure a gap of 20mm between panels**

If you want to expand the size of your Vertical Garden, or install automatic irrigation for your Modiwall panel, please visit www.modiwall.com or contact the office on 012 661 0538 or info@modiwall.com for assistance.